

Made in Canada 

veil[®]
FORM OVER FUNCTION

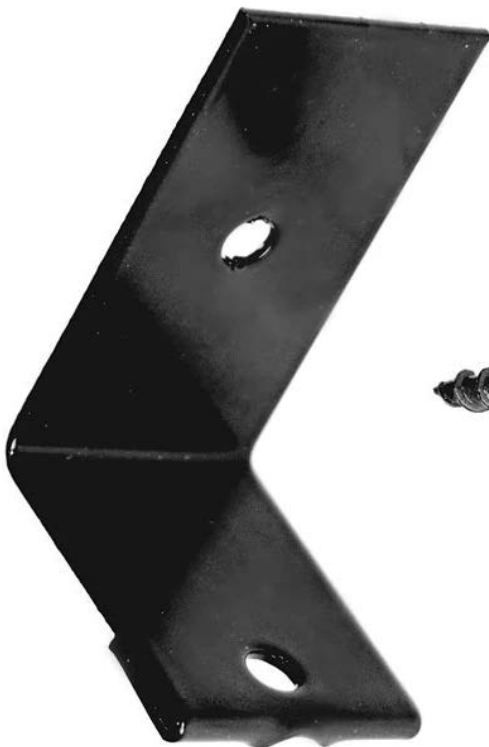

Mounting Bracket Installation

Adjusting Your Installation Height Using Mounting Brackets



WARNING

Sharp edges. Watch your fingers.

WHEN USING ELECTRICAL APPLIANCES, BASIC PRECAUTIONS SHOULD ALWAYS BE FOLLOWED TO REDUCE THE RISK OF FIRE ELECTRIC SHOCK, AND INJURY TO PERSONS, INCLUDING THE FOLLOWING:

1. Read all instructions before installing or using the cover.
2. Sharp edges and corners may be present on the baseboard cover panel. Any sharp edges will be covered after installation using the proper end cap. Please use caution during installation to avoid injury.
3. To avoid fire do not block air intakes or exhaust in any manner.
4. Do not insert or allow foreign objects to enter any ventilation or exhaust opening as this may cause and electric shock or fire, or damage the heater.
5. This heater cover is hot when in use. To avoid burns, do not let bare skin touch hot surfaces. Keep combustible materials such as furniture, pillows, bedding, papers, and curtains away from heater.

1 Remove the existing covers.

This process is different if you are covering hydronic (hot water) or electric heaters. Please follow the relevant steps below.

Hydronic Heaters:

Remove end caps on either side and then the front panel by snapping off from either top or bottom. **This can be done without tools.** If you can, remove the back plate and top fins as well, leaving just the heating element and the hot water pipes in place.

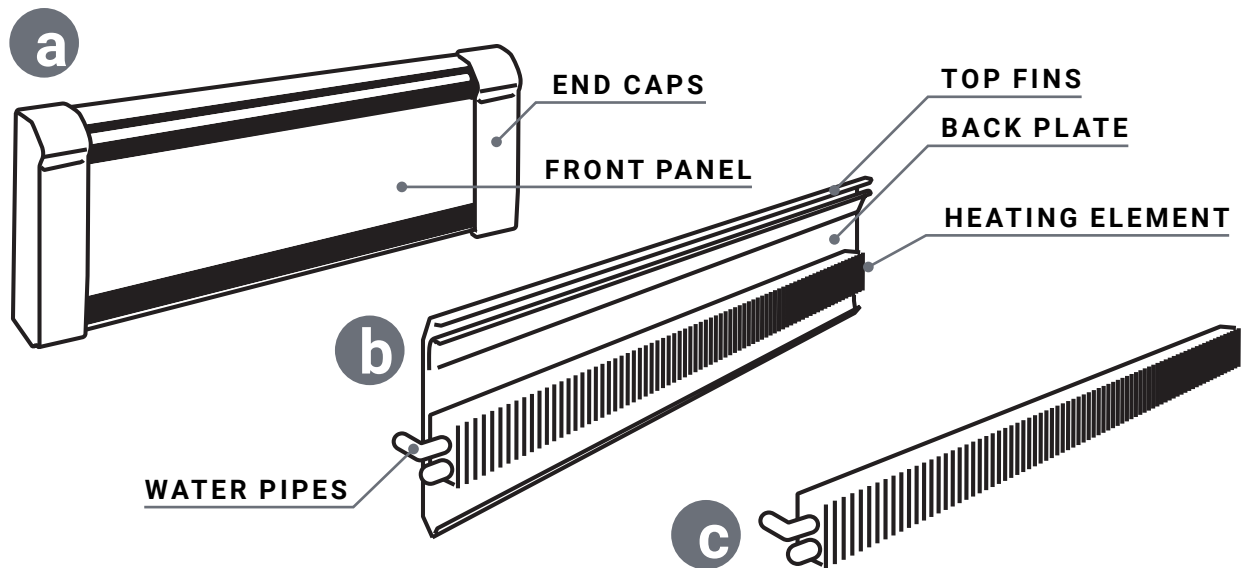

Electric Heaters:

Remove the front panel if possible. Using your hands only, gently unclip or remove the front panel. No tools should be necessary to do this. If this is not possible without tools, go directly to step 2, don't modify the electrical components.

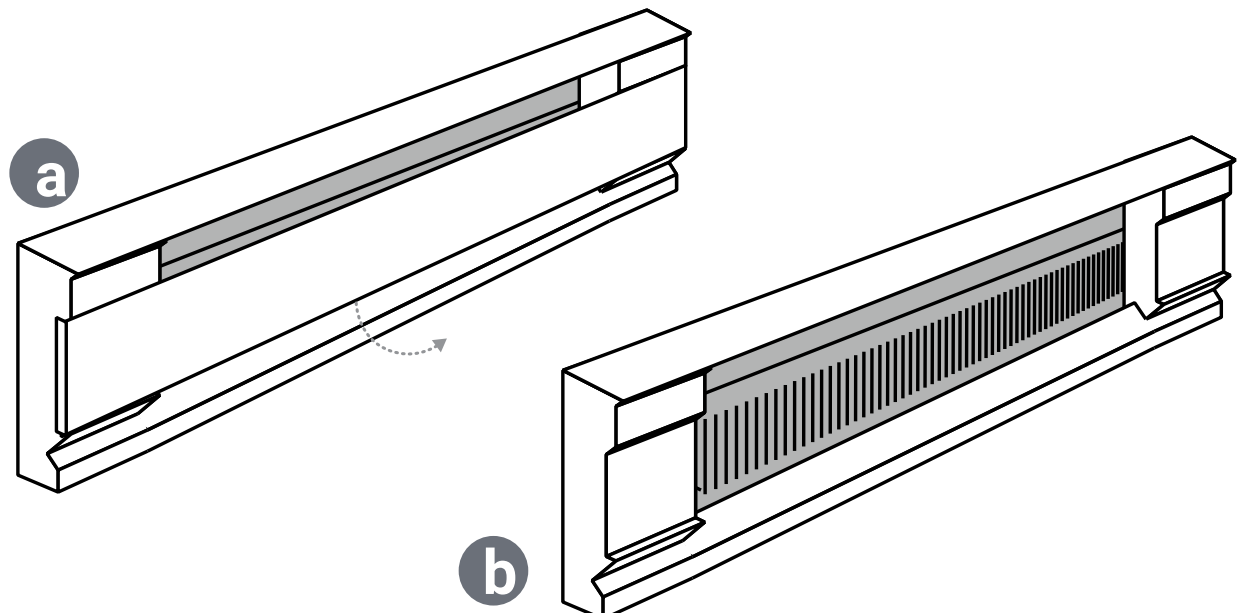

2 Measure the height from the floor.

Your panels will need to hang at least 7½" from the floor, in order to have enough clearance between the panel and the floor for proper airflow.

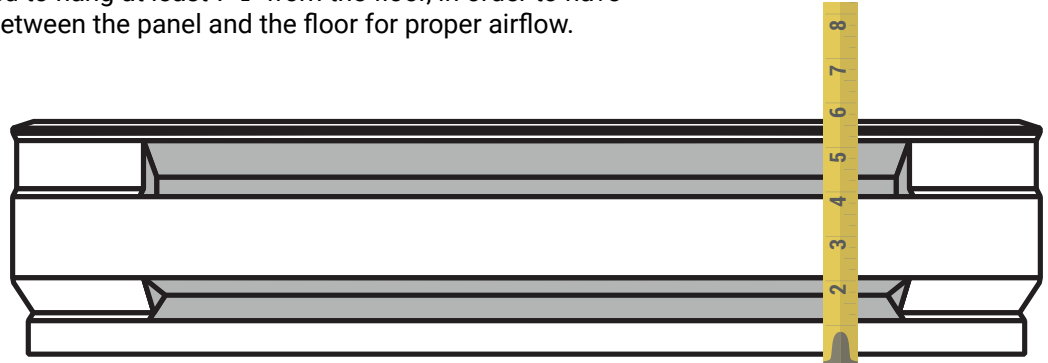

3 Install the mounting brackets.

The top edge of the installed mounting bracket needs to be a minimum of 7½" from the floor. Mark your locations at even intervals above the length of the baseboard heater, and screw into the wall.

How many brackets to hang depends on your cover length.

We made this chart to help you decide. For custom lengths, just choose the nearest foot length and hang them at an even interval along the wall.

| Length | No. of Brackets |
|--------|-----------------|
| 2 ft | 2 brackets |
| 3 ft | 2 brackets |
| 4 ft | 2 brackets |
| 5 ft | 3 brackets |
| 6 ft | 3 brackets |
| 7 ft | 4 brackets |
| 8 ft | 4 brackets |



Please make sure there is a clearance of **at least ¾ of an inch** between the heater cover and the floor to ensure proper air flow.

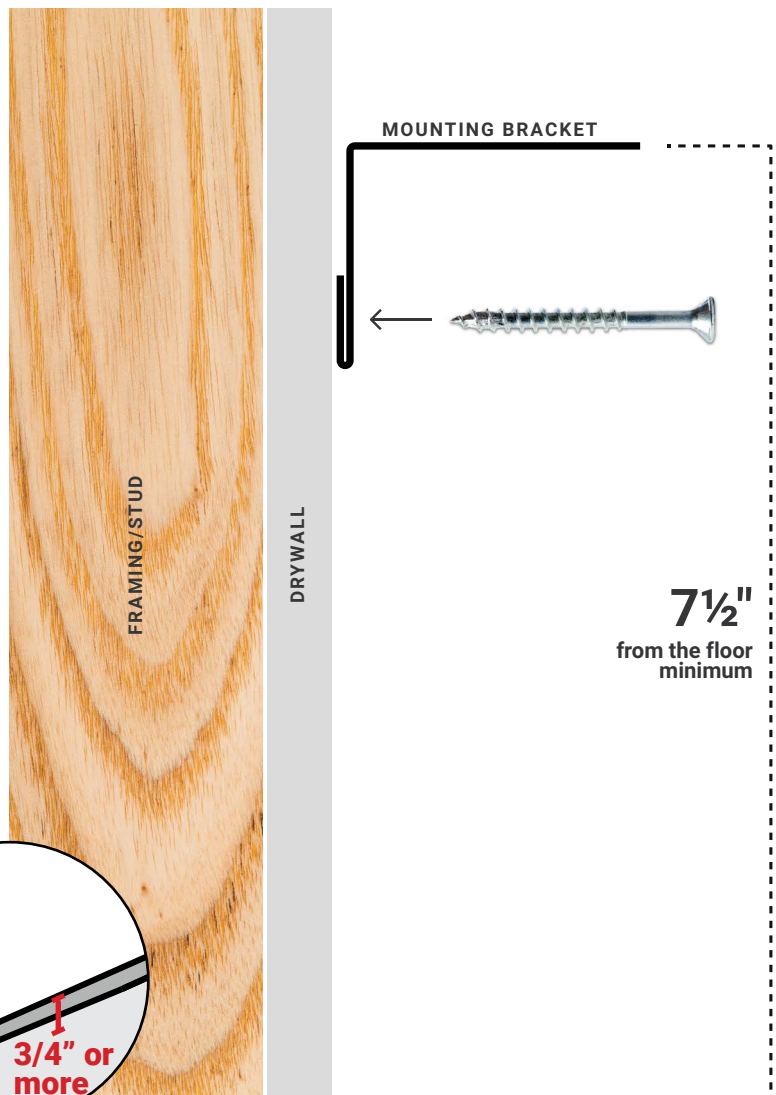
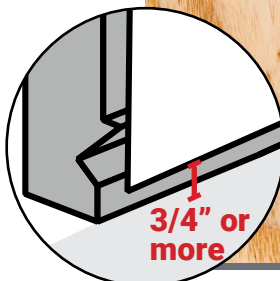

4 Install the panel over the brackets.

Press the top edge along the top of the mounting brackets, with the edge sitting between the bracket and the wall.

Hydronic heaters without back plate:

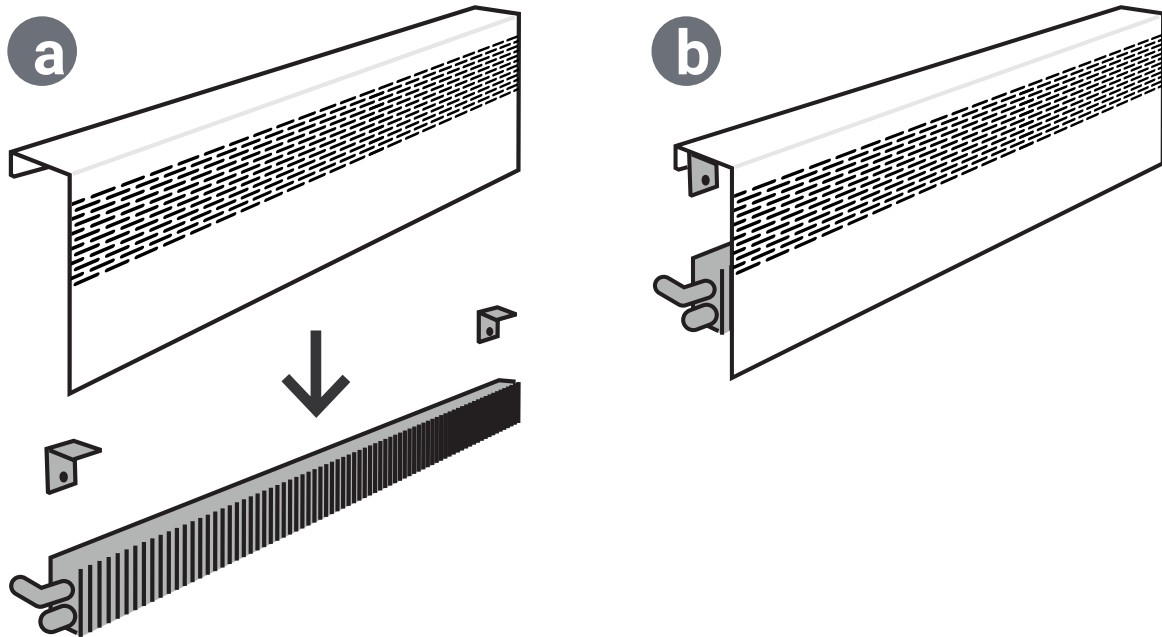

Hydronic heaters with back plate:

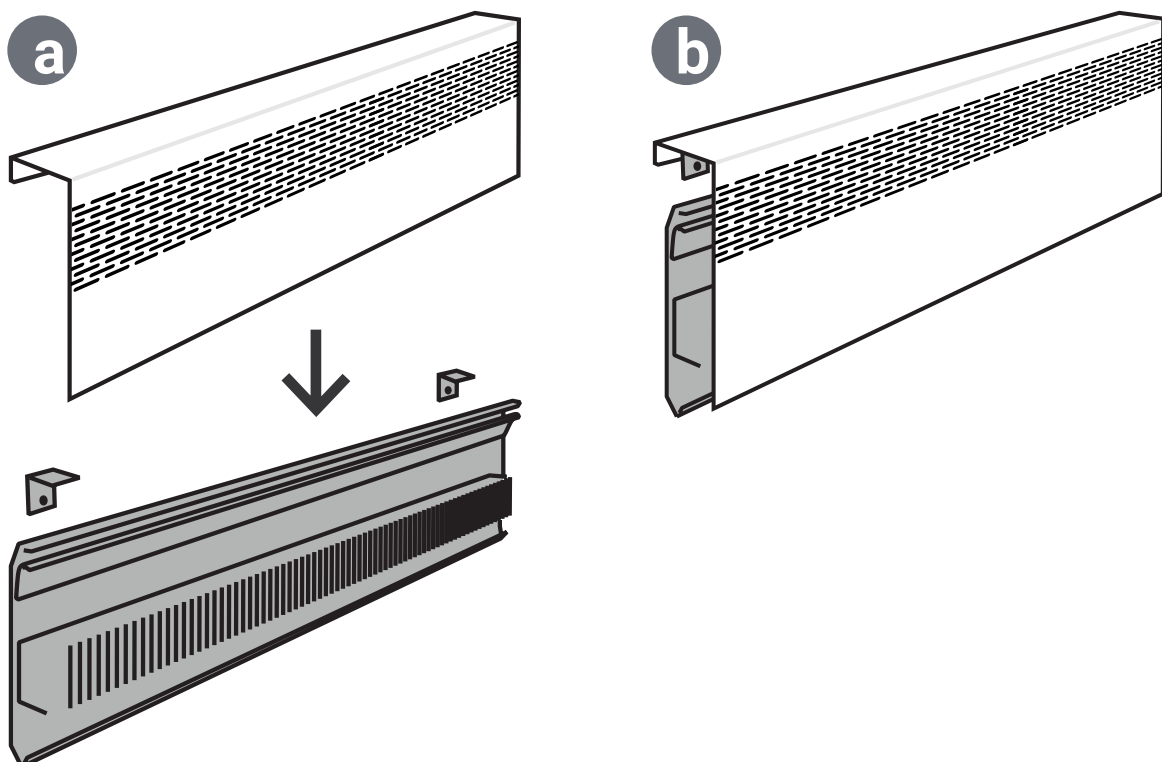

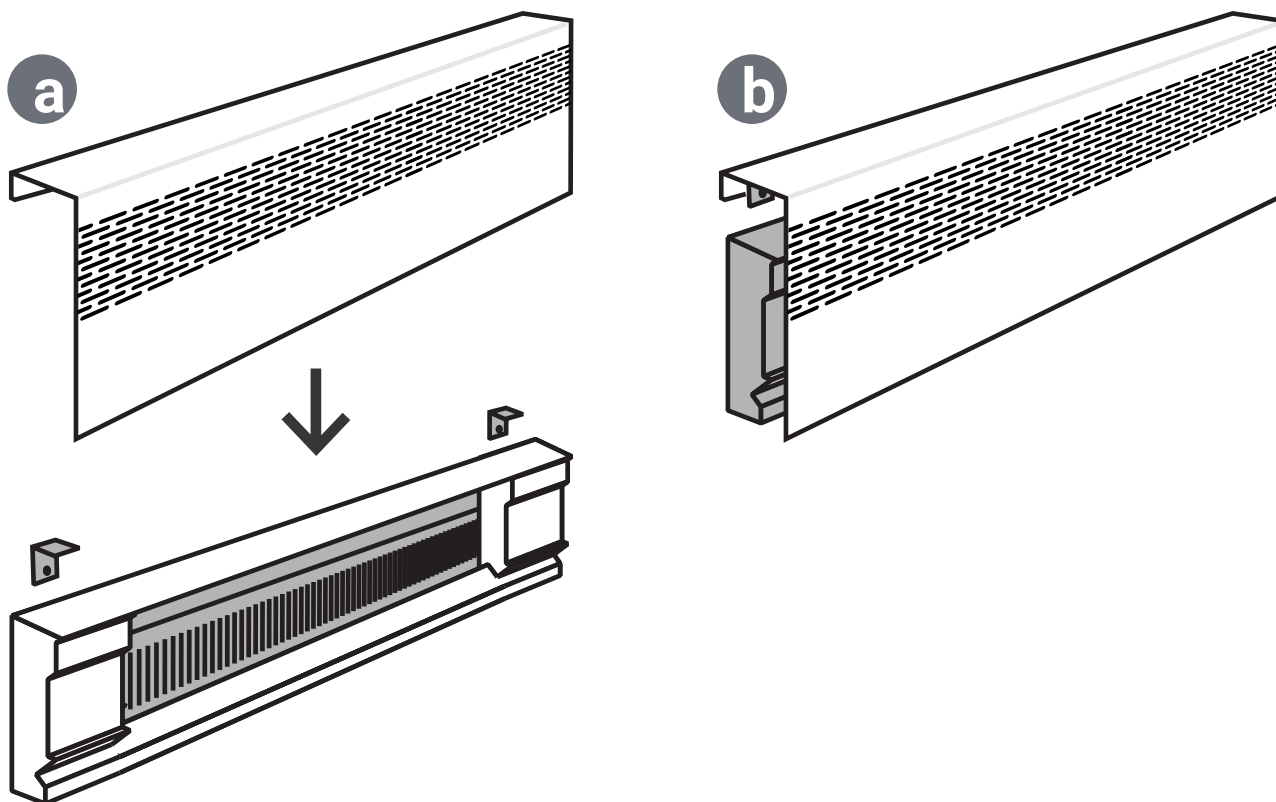
Electric heaters:**5****Install the end caps.**

Ensure your end caps will sit flush against the wall.

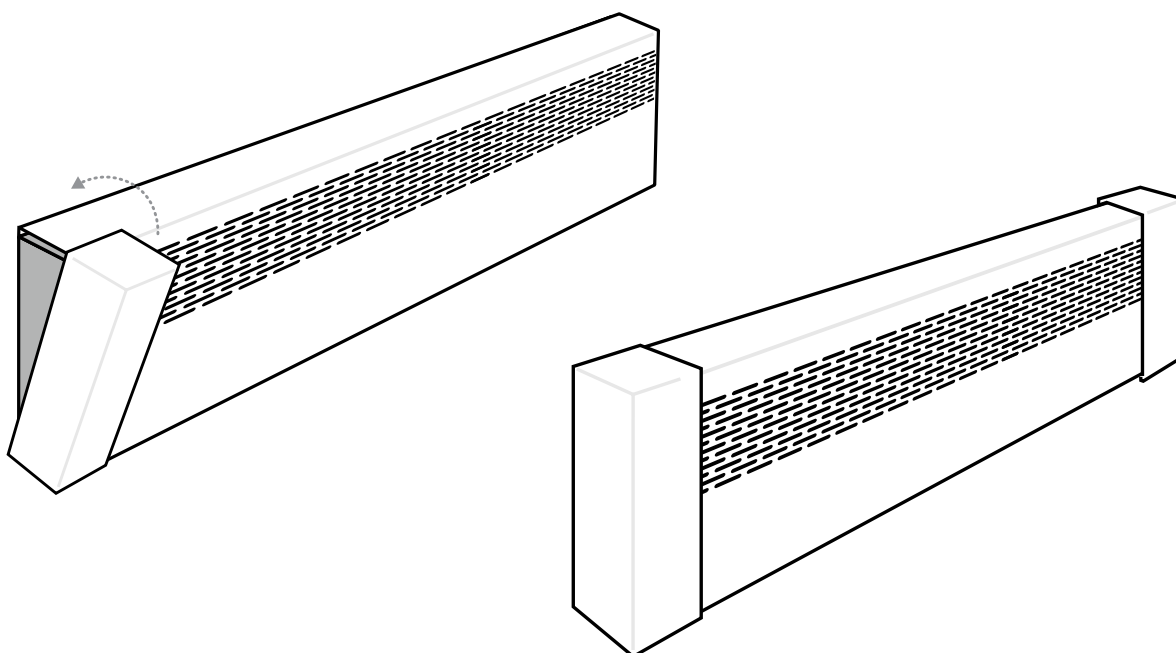

Combining multiple panels for extra long heaters.

You can join to adjacent panels using the coupler piece. Fit the coupler onto the bottom of the baseboard cover and then snap into place at the top.

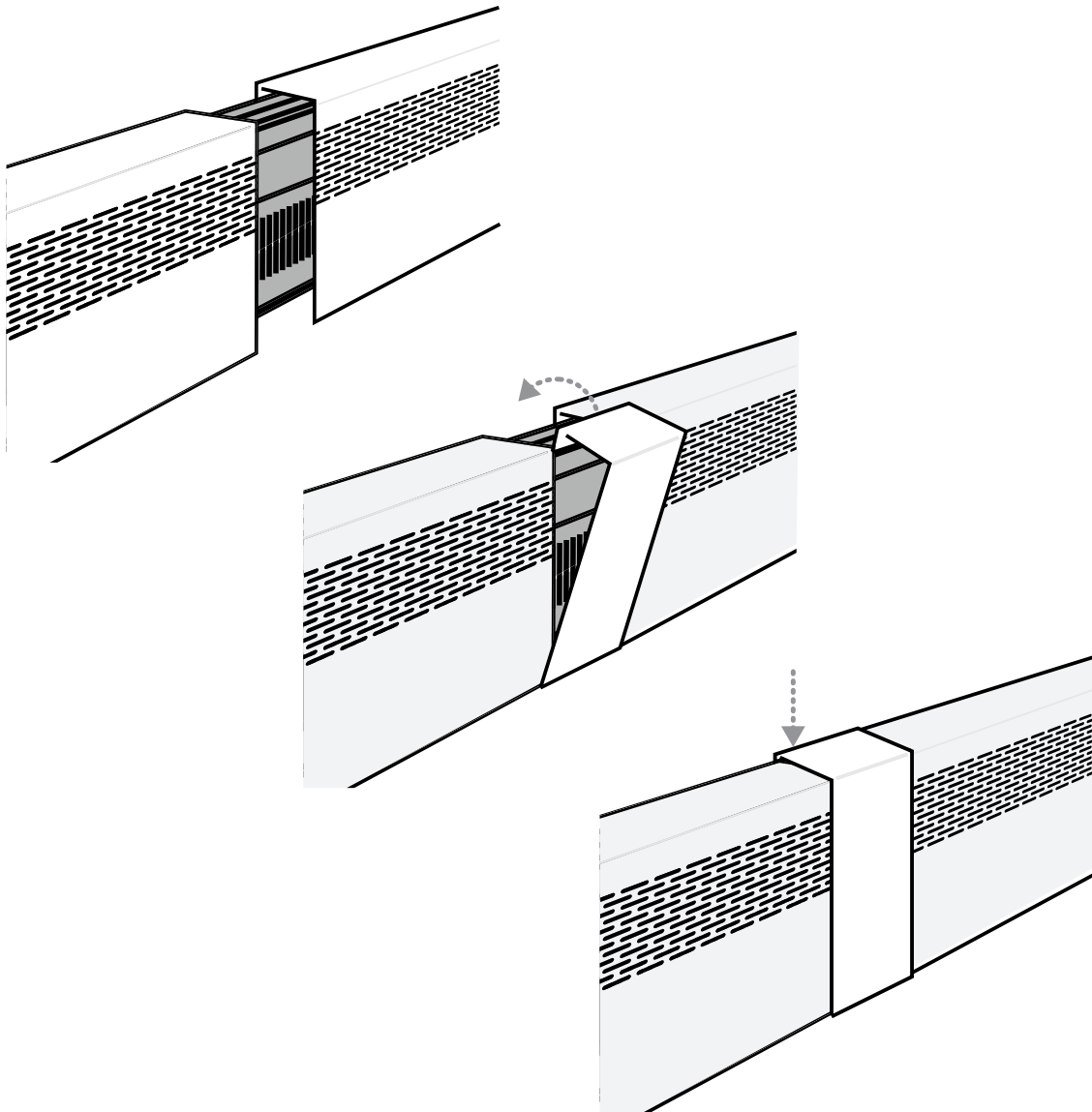

Questions? Call us.

Visit coversbyveil.com/contact-us or call us at 1-833-567-5050.

CONTACT US